

# 8614-22/8613-22\* 1/2"-3"

**Bronze Ball Valve  
Three Piece  
Full Port  
600 WOG  
Extended Tube Ends  
Inline Repairable  
Blow-Out Proof Stem  
MSS SP-110**

## MATERIALS LIST

ITEM	PART	MODEL/SIZE	MATERIALS	ASTM SPEC.
1	Body	8614-22/8613-22	Bronze	B584
2	Sil. Braised Stub, Male	8614-22/8613-22	Bronze, Copper Tube	
3	Ball	8614-22	Chrome Plated Brass	B16
		8613-22	316 Stainless Steel (1)	A276
4	Stem	8614-22	Brass	B16
		8614-22/8613-22	316 Stainless Steel (1)	A276
5	Seat	8614-22/8613-22	15% Glass RPTFE	
6	O-Ring	8614-22/8613-22	Viton	MIL-R-83248
7	Washer, Thrust	8614-22/8613-22	25% Glass RPTFE	
8	Packing	8614-22/8613-22	PTFE	
	Packing, Male	8614-22/8613-22	PTFE	
9	Packing, "V"	8614-22/8613-22	PTFE	
10	Packing, Female	8614-22/8613-22	PTFE	
11	Packing Follower	8614-22/8613-22	Brass	B16
12	Washer, Belleville	8614-22/8613-22	17-7 PH S.S.	Commercial
13	Nut Locker	8614-22/8613-22	S.S. 301	Commercial
14	Handle Assy	8614-22/8613-22	-	
15	Hex Head Cap Screw	8614-22/8613-22	SAE, Grade 8	Commercial
16	Nut, Jam	8614-22/8613-22	Steel, Zinc Plating	Commercial
17	Washer, Internal Tooth	8614-22/8613-22	Stainless Steel	Commercial
18	Socket Head Cap Screw	2-1/2"-3"	Commercial Carbon Steel	Zinc Plated
19	Gland Nut	1/2"-2"	Brass	B16
20	Hex Nut	1/2"-2"	Commercial	SAE 5140

(1) Ball and stem are stainless for 8613-22

\*\* Pressure temperature charts contain valve seat (1) Ball and stem are stainless for 350STE and body ratings for standard valves. Solder end valves are de-rated by the limitations of the joint as specified in ASME 16.18. Brazing installations can be likewise derated. Consult ASME 16.18 and the American Welding Society for the actual joint ratings of the material being used for the specific application. Pressure and Temperature ratings may be further derated in accordance with the pressure rating associated with the type of copper tube used for the stub end. Call the factory for accurate application data.

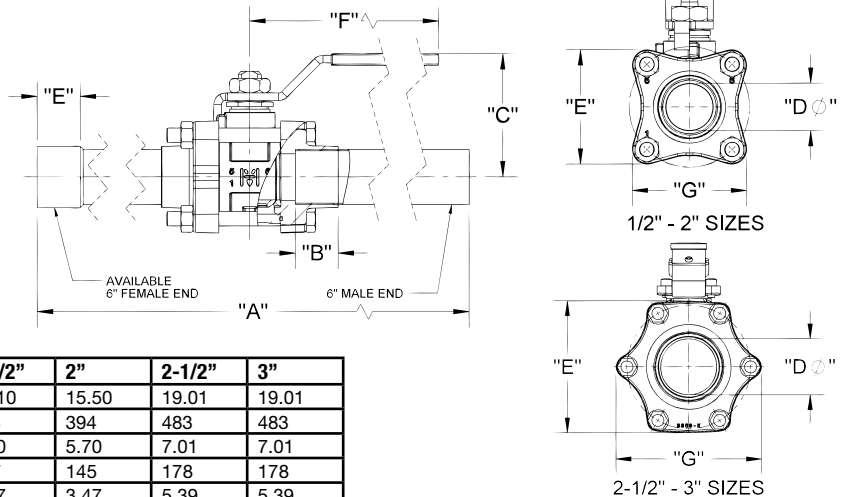

## DIMENSIONS

	UNITS	1/2"	3/4"	1"	1-1/4"	1-1/2"	2"	2-1/2"	3"
		A	INCHES	13.84	13.92	13.95	14.82	15.10	15.50
	mm	352	354	354	376	384	394	483	483
B	INCHES	3.02	3.56	3.81	4.66	5.00	5.70	7.01	7.01
	mm	77	90	97	118	127	145	178	178
C	INCHES	1.85	2.20	2.65	2.80	2.97	3.47	5.39	5.39
	mm	47	56	67	71	75	88	137	137
ØD	INCHES	0.50	0.75	1.00	1.25	1.50	2.00	2.44	2.91
	mm	13	19	25	32	38	51	62	74
E	INCHES	1.32	2.13	2.41	2.94	3.13	3.86	5.74	5.74
	mm	34	54	61	75	80	98	146	146
F	INCHES	1.92	2.13	2.41	2.94	3.13	3.86	6.31	6.31
	mm	49	54	61	75	80	98	160	160
G	INCHES	3.80	4.56	6.32	6.32	6.32	7.20	8.10	8.10
	mm	97	116	161	161	161	183	206	206
Cv		17	31	60	110	185	360	390	390

Note: DN (Diameter Nominal) = Metric equivalent size.

\* Designed for soft solder or brazed installation without disassembly.

\*Not intended for use in potable water.

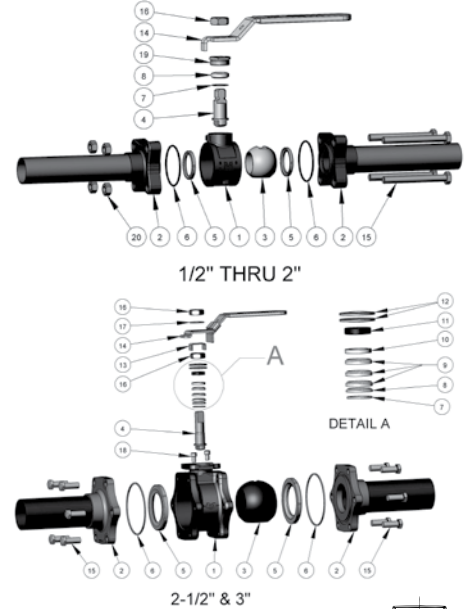

2-1/2" & 3"

### Available Options

- Male Tube Ends - Type "K" (Standard)
- Female Tube Ends - Type "L" (-F)
- Cleaned For Oxygen Service In Accordance With NFPA 99C (-OC)
- Stainless-Steel Ball And Stem (-S)
- Stainless-Steel Locking Lever (-LD)
- Oval Handle (-OH)
- Oval Locking Handle (-LO)
- Stem Extension (-XH)
- Stainless-Steel Lever Handle (-SH)
- Gauge Ports

The information presented on this sheet is correct at time of publication. Hammond Valve reserves the right to change design and/or materials without notice. For our Installation, Operation and Maintenance Manual and the most current product information go to [www.hammondvalve.com](http://www.hammondvalve.com). Hammond Valve is a registered trademark of Milwaukee Valve.

⚠ State of California Prop 65 **WARNING:** Cancer and Reproductive Harm. For more information visit [www.p65warnings.ca.gov](http://www.p65warnings.ca.gov).