

December 18, 2024

## Locking Extension for 35-Series Ball Valves Accommodates Insulation and Other Obstructions.

Did You Know that Milwaukee Valve has a locking stem extension option available for the **35 Series** carbon and stainless-steel three-piece ball valves?

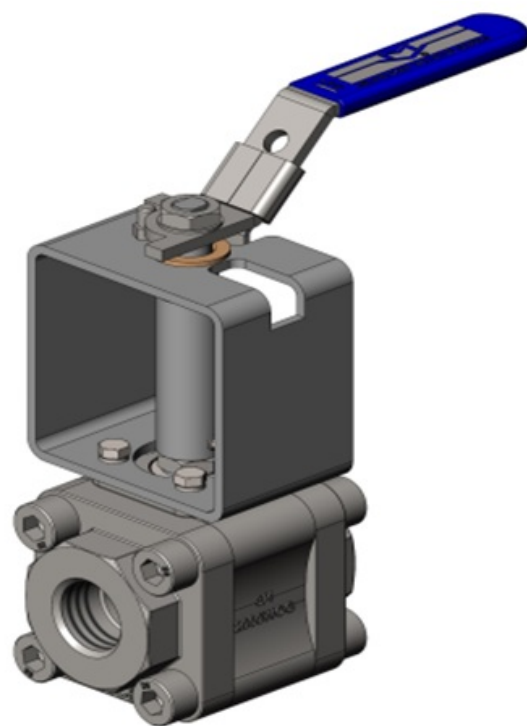

A locking lever handle is standard on the entire 35 Series. The -LXH extension option provides customers with the added benefit of adding a minimum of 3" to elevate the locking handle above the piping, ensuring adequate clearance for insulation and other obstructions and ease of operation.

Dimensional information and installation instructions for the -LXH extension can be found by clicking [HERE](#).

For pricing and lead-time information, contact your [Milwaukee Valve sales representative](#). For more information on 35-Series Ball Valves, visit the [Milwaukee Valve](#) website.

### Holiday Hours...

Our offices and manufacturing plants will be closed on December 24th, 25th, 30th, 31st, and January 1st in observance of the Christmas and New Year's holidays. The sales office will be open December 26th & 27th. During this time the plants will be performing maintenance and our annual physical inventory in the warehouse. The last day for shipments will be Monday, December 23rd. Please plan your inventory needs accordingly. We will be fully staffed on Thursday, January 2nd with normal operations in the office, plant and warehouse. We expect normal shipping to resume January 2nd.



MILWAUKEE VALVE

[www.milwaukeevalve.com](http://www.milwaukeevalve.com)  
262.432.2700



HAMMOND VALVE

[www.hammondvalve.com](http://www.hammondvalve.com)  
262.432.2702

16550 West Stratton Drive, New Berlin, WI 53151

